

## Tournament Euro Sport®

High performance Sports flooring with 2-layer engineered floorboards' top layer; intended for interiors used for training and holding all levels of sports competitions, including international tournaments in team sports, such as basketball, volleyball, handball, squash. Distinguished by a reduced deformation zone.

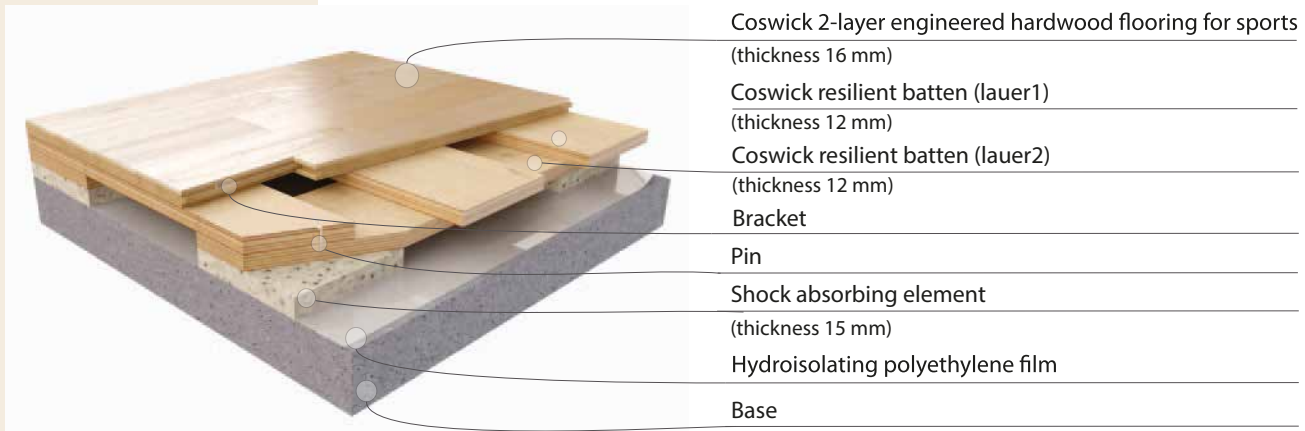

Intended Use	Product is intended for speciality indoor courts used for team sports and ball games; recommended for interiors with strict requirements in regards to the technical characteristics of the floor.
Technology	2-layer engineered flooring manufactured from hard wood species installed over shock-absorbing cross-laid batten system with high performance resilient shock-absorbing elements. Product has "deck"-style surface pattern.
Compliance with	
Shock absorption, %	62   EN 14808 (A4 ≥55% <75%)
Vertical deformation, mm	3,6   EN 14809 (A4 ≥2,3 <5,0)
Friction, nominal unit	97   EN 13036-4 (80-110)
Ball bounce, %	91   EN 12235 (≥90%)
Rolling load, mm	0,15   EN 1569 (≤ 0,5 mm, min. 1500 H)
Top Layer	
Species	Oak, ash
Construction	2-layer engineered hardwood floor board
Dimensions	16x107,95x300...1845 mm
Subfloor	Shock-absorbing cross-laid batten system with high performance resilient shock-absorbing elements.
System Type	Permanent stationary system, installed using floating method.
Warranties	Lifetime Structural Integrity Warranty

### Baseboard and Reducer

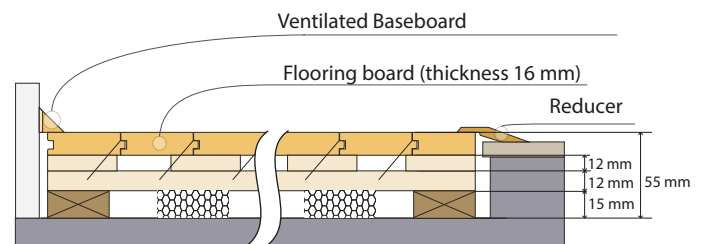

### Serviceable Cable Channel

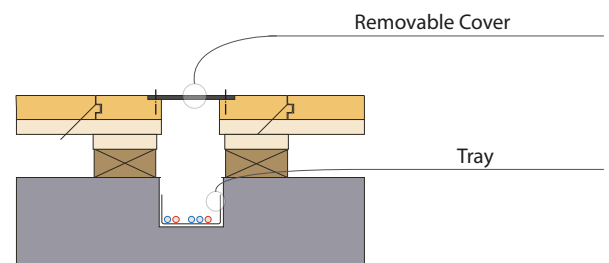

### Breakout Box

